



ACCOLADE SAFE PLUS

RECOMMENDED MAINTENANCE PROCEDURES

Initial Care:

After installation is completed:

1. Remove all debris (electrostatic mop, sweep or vacuum)
2. Damp mop using a pH 7.0-8.5 neutral cleaner (Armstrong ONCE 'N DONE)

Allow 48 hours before carrying out the following:

1. Remove all debris (electrostatic mop, sweep or vacuum)
2. Damp mop using a neutral cleaner (Armstrong ONCE 'N DONE), or if necessary light scrub with a **soft bristled broom** or a 175-400 rpm auto scrubber (Polivac, Rotowash, Duplex or similar) using a bassine or similar brush and neutral cleaner (Armstrong ONCE 'N DONE). (**Ensure floor area is wet**), [If floor is badly soiled, strip back using a low alkali stripper (Armstrong NEW BEGINNING), diluted as per manufacturers instructions].
3. Rinse floor thoroughly with clean water

Routine care:

Daily: Sweep, vacuum, static mop. Regularly damp mop and wet scrub; use neutral cleaner (Armstrong Once 'n Done). Frequency and type of maintenance required depends on traffic flow, application, environmental conditions and customer requirements. Light and accent colours can require more maintenance, where practical choose darker, more camouflaging colours.

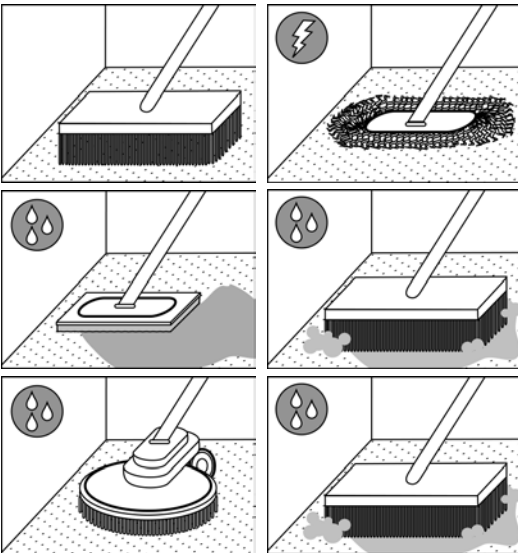

Daily: Sweep, static dust mop, vacuum thoroughly to remove all dirt and dust.

Daily / Regular: Damp Mop (Nylon/Rayon)

Regular: Small areas and confined spaces (such as Ensuities), Wet Scrub using soft bristled broom and neutral cleaner (Armstrong Once 'n Done).

(Do not use caustic or solvent agents such as toilet bowl cleaner).

Regular: Large & unobstructed areas, Wet Scrub using auto scrubber, (Rotowash, Duplex Polivac or similar use bassine or similar brush only) and neutral cleaner (Armstrong Once 'n Done).

Spot scrub around edges & fixtures using a soft bristled broom.

(Do not use caustic or solvent agents such as toilet bowl cleaner).

Protection:

1. Use walk-off mats that are as wide as the doorway entrances and long enough (min 3 average paces) to trap dirt before reaching the resilient floor. Ensure that walk-off mats are cleaned frequently.
2. Sand and grit are abrasive and can damage floors; stopping dirt at the entrance means less dirt trafficked through the building, protecting your investment and helping keep maintenance costs down.
3. Ensure all furniture legs have well maintained non-abrasive feet. Exposed metal legs can damage flooring.

Stain Removal:

1. Treatment should be carried out when stains are fresh, immediately remove contaminant.
2. Spot clean with a neutral floor cleaner using soft nylon brush. After stains have been removed, rinse floor with clean water and allow to dry.

General Hints

- **DO NOT USE** floor maintenance pads on this product; Slip resistant flooring should not be burnished or buffed.
- **DO NOT USE** caustic or solvent products such as toilet bowl cleaner, benzine, toluol, acetone, trichloroethene, thinner, oilwax or strong scouring powders, as these will damage the floor.
- **Unless specified DO NOT USE** sealers or polish on slip resistant floors as this can adversely affect the slip resistant properties of the floor.
- Adhesive residue may be removed using a clean white cloth dampened with small amounts of mineral turps, carefully following warnings on container, immediately rinse with clean water (test in inconspicuous area first)
- Auto scrubbing in unobstructed areas takes approximately 20% of the time of damp mopping. For maximum efficiency use damp mopping in obstructed areas only.
- **Spillages** – post wet floor signs and wipe up immediately. Allow to dry and remove signs.
- All resilient flooring should be protected during the construction period.

For further Armstrong information:

Freecall 1800 632 624

www.armstrong-aust.com.au