

NOTICE: Shasta II, Altair, Meridian, Summit Hill and Quadric are available ONLY in Premier construction. All other door styles are available in Premier or Allwood construction.



# CABINET SPECIFICATIONS

**HANGING RAILS** - Wall cabinets have nominal 3/4" thick (18mm) x 3" high multi-ply hardwood plywood or 3/4" thick x 3 7/16" high solid lumber with white laminate. Each is running full cabinet length at the top and bottom. Base cabinets have a nominal 1/2" thick (12mm) x 3" high industrial grade composite panel with maple grained or white laminate at the top.

**BACK PANELS** - 1/8" Hardboard with maple grained or white interior surface.

**TOP/BOTTOM PANELS** - Nominal 1/2" thick (12mm) Industrial grade, wood based composite panel with maple grained or white laminate on exterior and interior surfaces for wall cabinets and interior surface for base cabinets.

**SHELVES** - Nominal 5/8" thick (15mm) industrial grade wood based composite panel with maple grained or white laminate on both faces and matching edgeband on facing edge. Shelves are adjustable in all standard wall and base cabinets.

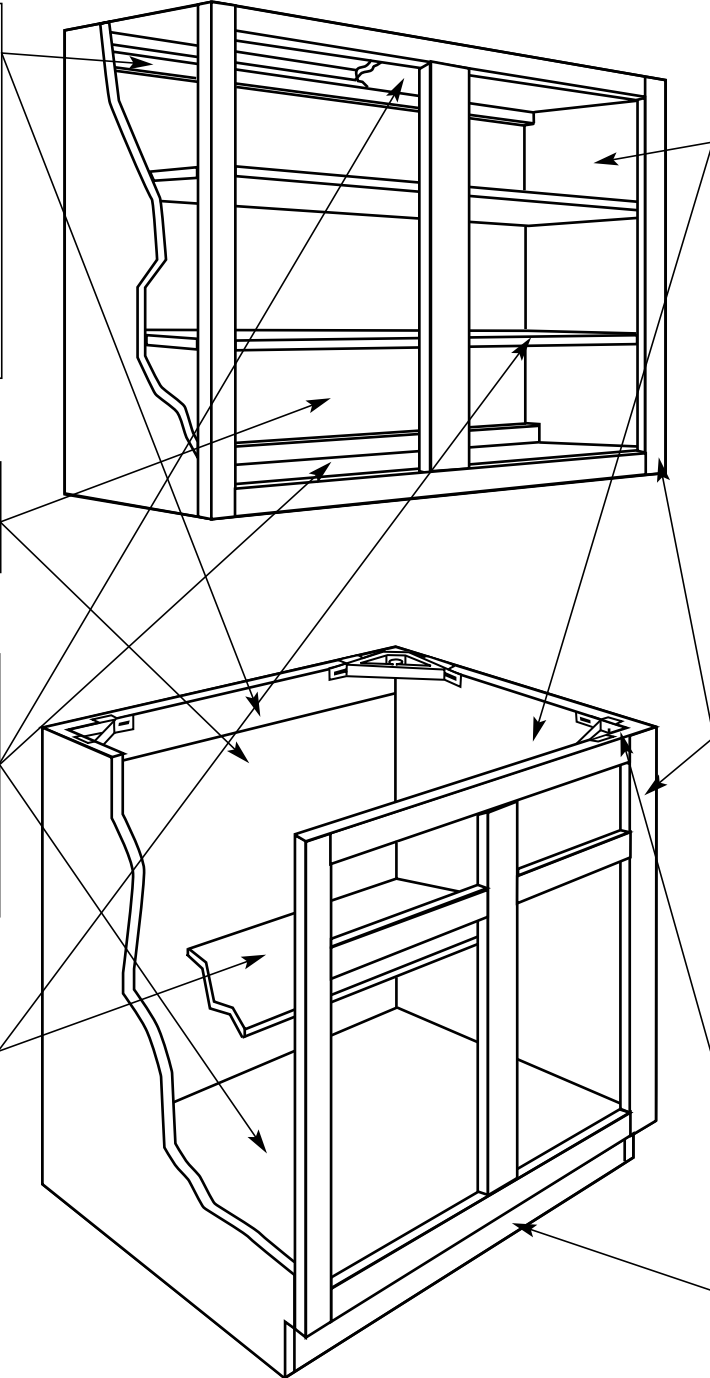

**END PANELS** -  
**STANDARD:** Nominal 1/2" thick (12mm) industrial grade, wood based composite panel dadoed to receive tops and bottoms, with wood grained or white laminate on exterior surface. Maple grained or white laminate on interior surface. All end panels are inserted into dado in face frame and recessed 3/16".  
**UPGRADE OPTION:** Nominal 1/2" thick (12mm) multi-ply hardwood plywood with oak, birch or cherry veneer on exterior surface and birch veneer on interior surface. All end panels are constructed with the same dado joinery as above and are recessed 3/16".

**FRONT FRAMES** - Kiln dried solid oak, maple, cherry, aspen, birch or rubberwood (wood door styles) or thermofoil vinyl wrapped LVL linear veneer lumber (thermofoil and laminate door styles). Assembled with mortise and tenon or bore and dowel construction. 3/4" x 1 1/2" Vertical stiles. 3/4" x 1 3/4" Horizontal rails. 3/4" x 3" Center mullion on two door cabinets.

**BASE CORNER BRACES** - High impact, injection molded plastic.

**TOE KICK** - 1/2" Thick industrial grade, unfinished wood based composite panel captured between end panels.

**DRAWERS** - (Standard) Front, back and sides are nominal 1/2" thick (12 mm) solid wood. Drawer bottoms are nominal 1/4" (6 mm) multi-ply hardwood plywood inserted into dado in front, back and sides. All drawer parts glued and stapled together.  
**DRAWER GUIDES** - High quality epoxy coated steel, Cushion-Tec, side mounted guides, self adjusting in mounting brackets. Built-in stop, self-closing and stay-closed features with a 100 lb. rated load capacity.  
**HINGES** - (Standard on all doors) Heavy duty, high quality steel, concealed hinge with self-closing feature. (Optional) High quality steel wrap-around hinge with self closing feature (available on standard reveal door styles only).

**DOVETAIL DRAWER** (Upgrade option) - Front, back and sides are nominal 5/8" thick (16 mm) solid beech hardwood with dovetail construction. Drawer bottoms are nominal 3/16" (5 mm) multi-ply hardwood birch plywood inserted into dado in front, back and sides. Drawer bottoms are glued and stapled to sides.  
**UNDERMOUNT DRAWER GUIDE** (Standard with dovetail drawer only) - High quality steel, undermount construction provides full drawer access. Self adjusting in mounting brackets. Built-in stop, self-closing and stay closed features with a 75 lb. rated load capacity.  
**FINISH** - Furniture quality protective finish system on doors, drawer fronts, front frames and veneer plywood end panels consisting of sanding, stain, catalyzed sealer and catalyzed clear top coats.