

EXTREME SPECIFICATIONS

EXTREME DOOR STYLE AVAILABILITY:

OAK

Branford
Hampton
Hampton Arch

PLANTATION HARDWOOD

Bali
Coronet

BIRCH

Siena
Tuscany

MAPLE

Berkshire
Berkshire Arch
Caruth
Rutledge

FINISH AVAILABILITY:

OAK

Chestnut
Honey
Mocha

PLANTATION HARDWOOD

Chestnut
Honey
Mocha

BIRCH

Toffee

MAPLE

Mocha
Toffee

EXTREME SERIES CABINET SPECIFICATIONS

FRONT FRAME: 3/4" Thick kiln dried solid hardwood. Mortise and tenon or bore and dowel construction frame joinery reinforced with glue and nail. Stiles 1 1/2" wide. Mulls 3" wide. Rails 1 3/4" wide. Stiles and top and bottom rails dadoed to receive ends, tops and bottoms.

END PANELS:

Standard: Nominal 1/2" thick (12mm), multi-ply Type I exterior glue hardwood plywood, dadoed to receive tops and bottoms. Ends are inserted into dado in face frame and recessed 3/16" and rabbeted to receive backs.

Upgrade Option: Nominal 1/2" thick (12 mm), multi-ply hardwood plywood with oak veneer on exterior surface and birch veneer on interior surface. All end panels are constructed with the same joinery as noted above.

TOP/BOTTOM PANELS: Nominal 1/2" thick (12 mm), multi-ply hardwood plywood. Tops and bottoms let into end panels, front rails and hang rails, glued and stapled. Bottoms are supported at rear of base cabinets by nominal 1/2" thick multi-ply hardwood plywood.

HANGING RAILS: Wall cabinets: nominal 3/4" thick (18 mm) x 3" high multi-ply hardwood plywood, running full cabinet length at the top and bottom. Base cabinets: nominal 3/4" thick (18 mm) x 7 1/4" high solid pine at the top. All hang rails are rabbeted to inset in end panels and to receive backs.

BACK PANEL: Nominal 1/4" thick (5.2 mm), hardwood plywood. Securely glued and stapled to rabbets in ends and hang rails.

SHELVES: Nominal 1/2" thick (12 mm), multi-ply hardwood plywood, 10 7/8" deep with hardwood veneer banded front edge. Shelves are fixed into dadoes in end panels on all cabinets.

TOE BOARD:

Standard: Nominal 3/4" thick (18 mm), ACQ* pressure treated toe board captured between end panels.

Upgrade Option: 3-sided ACQ* pressure treated toe board attached inside end panels, with same specifications as above.

BASE CORNER BRACES: Two 3/4" x 1 1/2" solid hardwood or hardwood plywood corner braces running full depth front to back of cabinet. All braces are glued and pinned at top of cabinet to front frame, rear hanging rails and end panels.

DRAWERS: 1 1/16" thick solid pine lumber four sided drawer box. Ends are captured in drawer side dadoes. Drawer bottoms are nominal 1/4" thick (5.2 mm) hardwood plywood dadoed into all four drawer box sides. All drawer parts are glued and stapled together.

DRAWER GUIDES: High quality epoxy coated steel, Extreme grade, side mounted guides, self adjusting in mounting brackets. Mounting brackets are screwed to solid pine back hanging rails. Built-in stop, self-closing and stay-closed features with a 100 lb. rated load capacity.

HINGES:

Standard: High quality steel wrap-around hinge with self closing feature. (Standard reveal door styles only).

Optional: Heavy duty, high quality steel, concealed 6-way adjustable hinge with self-closing feature. (Not available on Traditional birch door)

FINISH: Furniture quality protective finish system on doors, drawer fronts, front frames and veneer end panels consisting of sanding, stain, catalyzed sealer and catalyzed clear top coats.

DOOR STYLE: See color brochure for availability.



EXTREME SERIES UPGRADE NOMENCLATURE

Wall Cabinet with Oak Veneer Plywood End Panels: WOVEP (price per cabinet)
Base Cabinet with Oak Veneer Plywood End Panels: BOVEP (price per cabinet)
Tall Cabinet with Oak Veneer Plywood End Panels: TOVEP (price per cabinet)

*Toe Board is made of "ACQ" Alkaline Copper Quaternary pressure treated lumber meeting AWPA Standard C2. The EPA awarded its "Presidential Green Chemistry Challenge Award" to Chemical Specialties, Inc. the developer of ACQ, an industry leader in non-arsenic wood preservatives.

EXTREME SERIES CABINET SPECIFICATIONS

HANGING RAILS -

Wall cabinets: nominal 3/4" thick (18 mm) x 3" high multi-ply hardwood plywood, running full cabinet length at the top and bottom. Base cabinets: nominal 3/4" thick (18 mm) x 7 1/4" high solid pine at the top. All hang rails are rabbeted to inset in end panels and to receive backs.

BACK PANELS -

Nominal 1/4" thick (5.2 mm), hardwood plywood. Securely glued and stapled to rabbets in ends and hang rails.

TOP/BOTTOM PANELS -

Nominal 1/2" thick (12 mm), multi-ply hardwood plywood. Tops and bottoms let into end panels, front rails and hang rails, glued and stapled. Bottoms are supported at rear of base cabinets by nominal 1/2" thick multi-ply hardwood plywood.

SHELVES - Nominal 1/2" thick (12 mm), multi-ply hardwood plywood, 10 7/8" deep with hardwood veneer banded front edge. Shelves are fixed into dados in end panels on all cabinets.

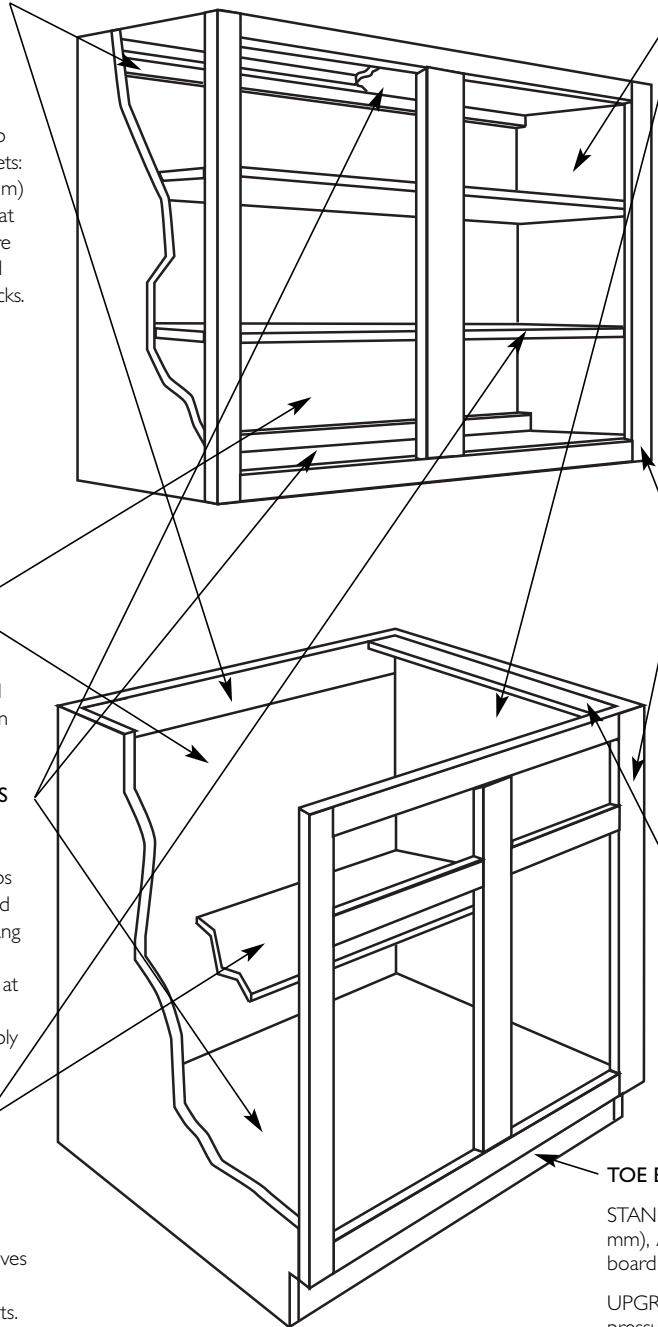

END PANELS -

STANDARD: Nominal 1/2" thick (12 mm), multi-ply Type 1 exterior glue hardwood plywood, dadoed to receive tops and bottoms. Ends are inserted into dado in face frame and recessed 3/16" and rabbeted to receive backs.

UPGRADE OPTION: Nominal 1/2" thick (12 mm), multi-ply hardwood plywood with oak veneer on exterior surface and birch veneer on interior surface. All end panels are constructed with the same joinery as noted above.

FRONT FRAME - 3/4" thick kiln dried solid hardwood. Mortise and tenon or bore and dowel construction frame joinery reinforced with glue and nail. Stiles 1-1/2" wide. Mulls 3" wide. Rails 1-3/4" wide. Stiles and top and bottom rails dadoed to receive ends, tops and bottoms.

BASE CORNER BRACES - Two 3/4" x 1 1/2" solid hardwood or hardwood plywood corner braces running full depth front to back of cabinet. All braces are glued and pinned at top of cabinet to front frame, rear hanging rails and end panels.

TOE BOARD -

STANDARD: Nominal 3/4" thick (18 mm), ACO* pressure treated toe board captured between end panels.

UPGRADE OPTION: 3-sided ACO* pressure treated toe board attached inside end panels, with same specifications as above.

EXTREME SPECIFICATIONS

EXTREME DOOR STYLE AVAILABILITY:

OAK
Branford
Hampton
Hampton Arch

PLANTATION HARDWOOD
Bali
Coronet

BIRCH
Siena
Tuscany

MAPLE
Berkshire
Berkshire Arch
Caruth
Rutledge

FINISH AVAILABILITY:

OAK
Chestnut
Honey
Mocha

PLANTATION HARDWOOD
Chestnut
Honey
Mocha

BIRCH
Toffee

MAPLE
Mocha
Toffee

DRAWERS - 1 1/16" thick solid pine lumber four sided drawer box. Ends are captured in drawer side dados. Drawer bottoms are nominal 1/4" thick (5.2 mm) hardwood plywood dadoed into all four drawer box sides. All drawer parts are glued and stapled together.

DRAWER GUIDES - High quality epoxy coated steel, Extreme grade, side mounted guides, self adjusting in mounting brackets. Mounting brackets are screwed to solid pine back hanging rails. Built-in stop, self-closing and stay-closed features with a 100 lb. rated load capacity.

HINGES - Standard – High quality steel wrap-around hinge with self closing feature (standard reveal doors only).

Optional – Heavy duty, high quality steel, concealed 6-way adjustable hinge with self-closing feature.

(Not available on Traditional birch door).

extreme
SERIES